









Le Foyer

Total de lits: 24

Légende:

-  = Petite commode
-  = Lit superposé (bas)
-  = Lit superposé (haut)
-  = Lit simple
-  = Réfrigérateur
-  = Four
-  = Évier
-  = Rangement
-  = Sofa

*Chaque personne bénéficie d'un tiroir de rangement sous les lits

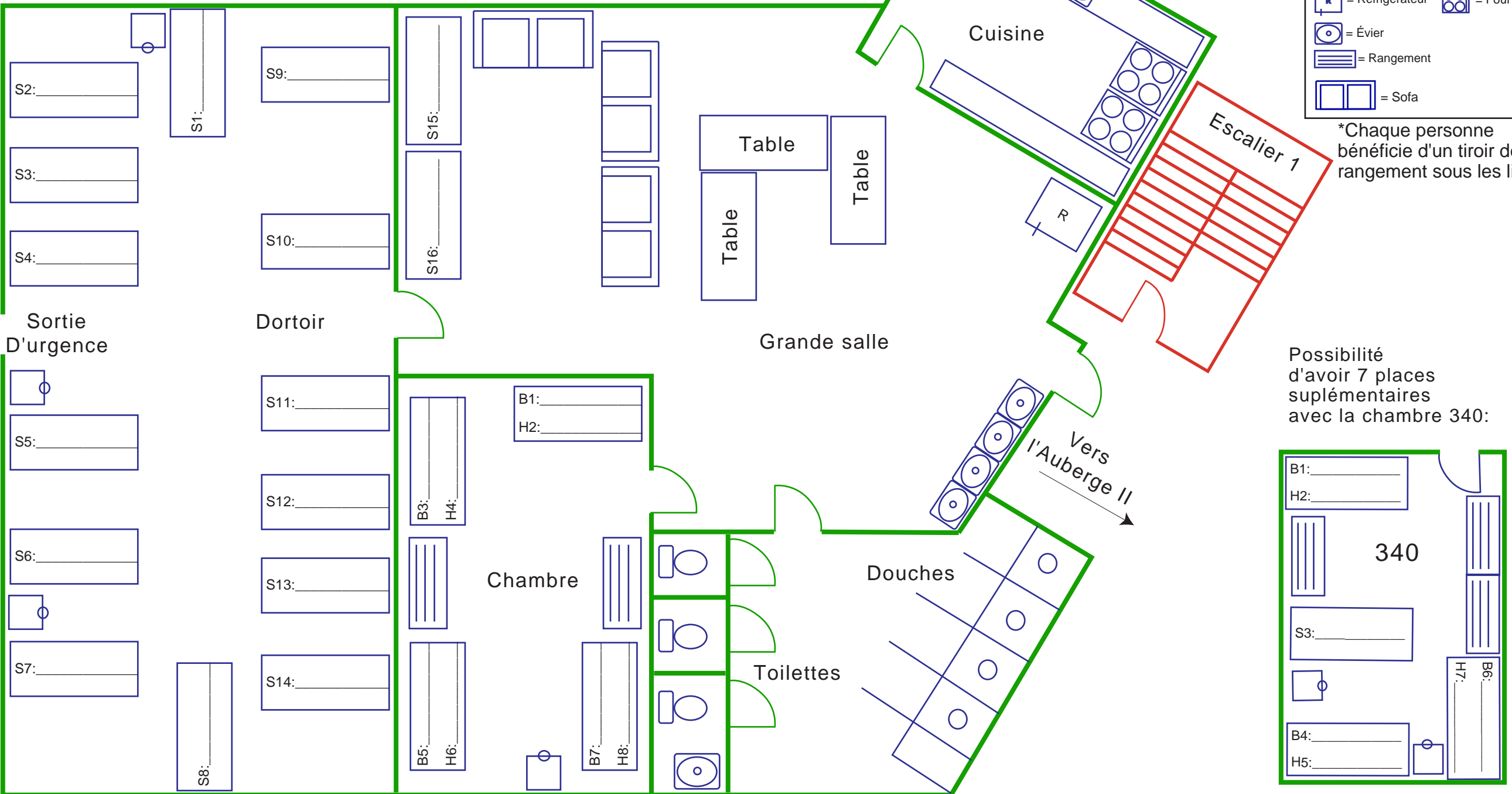

Possibilité d'avoir 7 places supplémentaires avec la chambre 340:

